

CLASSROOM

# HORSESHOE CAPACITY 50

PROJECT: None - Typical specification sheet

DATE: April 22, 2009

## 1: SPACE ALLOCATION

### 1.1

Capacity:	50
Typical NASM:	115
Typical NASM / Station:	2.3
Ceiling Height front:	minimum 10'6 clear height without obstruction ideal 12'+
Ceiling Height back:	unspecified

### 1.2

Wheelchair stations minimum 2

## 2: CONFIGURATION

### 2.1

#### Room Type and Seating Configuration

Classroom  
Lecture Style  
Horseshoe configuration  
Tiered  
Fixed continuous tables  
Loose seating

### 2.2

#### Spatial Relationships

Exterior (windows)  
Cluster with other classrooms on floor

### 2.3

#### Visual Relationships

Adjacent to corridor  
Vision panel in doors for visual link between corridor and room

### 2.4

#### Room Configuration

Projection (front) wall should be straight for the full width to allow for future additions of screens and equipment  
Space at front for wheelchair / Scooter  
Option: dropped ceiling gap at front to allow for 1' screen housing mount above clear ceiling level  
Prefer through aisles as per MW160 and Kaneff130  
Maximum 18% of seats outside of 90 degree viewing cone from center of screen

## 3: EQUIPMENT

### 3.1

#### **Fixed Equipment Included in base Contract**

Blackboards, stacked, in max. 8' wide sections, full length of room front  
Continuous curved tables min depth 18" – also see section 3 (Power)

### 3.2

#### **Fixed Equipment Infrastructure in Base Contract for Owner-Supplied Equipment**

1 power retractable projector screen – minimum 8' wide  
Ceiling or Wall mount Speakers  
Ceiling Mounted Data Projector  
Standard UT Teaching Station (electronic podium) – see appendix for specifications  
Roll-up blind window covering – power or manual

### 3.3

#### **Moveable Equipment (Owner-Supplied Equipment)**

Document camera (optional – can be affixed to Teaching Station shelf)  
Ergonomically designed armless chairs  
    Examples: KI Perry (sled base), KI Torsion (wheeled)  
    Minimum 10 year warranty

## 4: SERVICES

### 4.1

#### **Lighting**

Separate light control for the blackboard / screen area  
Dimmable / banked lighting with a minimum of 3 independently switchable zones:  
    Blackboard, instructor, student  
    Student zone should have minimum 3 light levels, ex.: low, 50%, 100%.  
Parallel switching of lights in banks parallel to front of room  
Manual control on side wall  
Ease of maintenance  
Minimum 50 FC all seats at desk height

### 4.2

#### **Power**

Standard 120V/15A duplex (or quadplex) outlet locations:  
1 @ front centre, 1 @ front side  
1 @ back centre  
1 @ each side wall  
1 by entry door for housekeeping purposes  
This in addition to duplex mounts on Standard Teaching Station  
1 @ end of each row of fixed tables, as part of table millwork. Post mount, not surface mount.

### 4.3

#### **Phone**

none

### 4.4

#### **Data**

Wireless communication is expected in all new U of T builds  
Wireless connection in ceiling, estimated every 50m arranged in a grid pattern

#### **4.5**

##### **HVAC**

System must not produce background noise or vibration that could be annoying to this facility's users

Local control with zone, individual thermostatic control is desirable

Even temperature / airflow across teaching area

#### **4.6**

##### **Plumbing**

Not required

### 5: FINISHES and OTHER CONSIDERATIONS

#### **5.1**

##### **Special Finishes**

All finishes must be attractive, durable (graffiti resistant surfaces) and easily maintained

Light colour wall finish

Ceiling and walls should be finished as required for optimal acoustics

No carpet

#### **5.2**

##### **Special Requirements**

Sound attenuation between rooms/areas and circulation space

#### **5.3**

##### **Safety & Security**

Lockable door(s) with electrically wired hardware and network connections

Hard key override required, lever handles typical

### 6: SAMPLE ROOMS

Page following

## 6.1

**MW 160** (picture: MW 110)

Scarborough Campus

Capacity 60

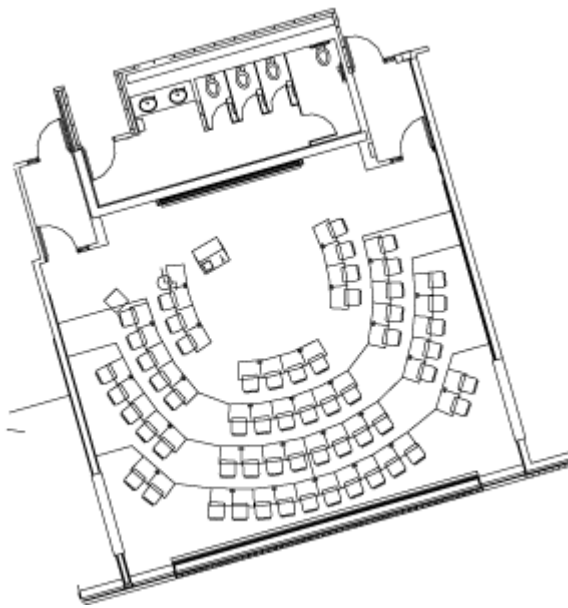

### Pros

Well liked by lecturers and students

Good layout

Sound protection via entrance vestibules

Second drop ceiling provides separate lighting grid over teaching area

### Cons

16' blackboards too wide for raise/lower operation

Dark wall finish in MW160 unappealing

Power mount covers in table tops broken

Questionable durability for height adjustable fully upholstered seating

Oversize custom table/podium too large and low

6.2  
Kaneff 130  
Mississauga Campus

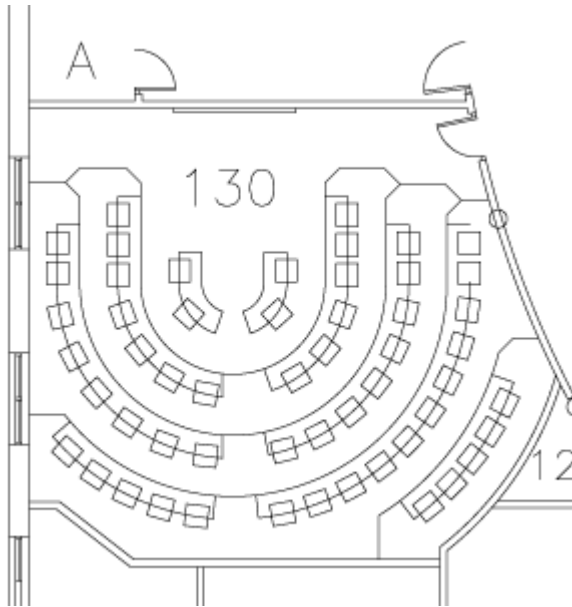

Pros

Cons

Lighting grid perpendicular to room front

**6.3**  
Bahen 024  
St. George Campus



All Photos Copyright OSM University Of Toronto

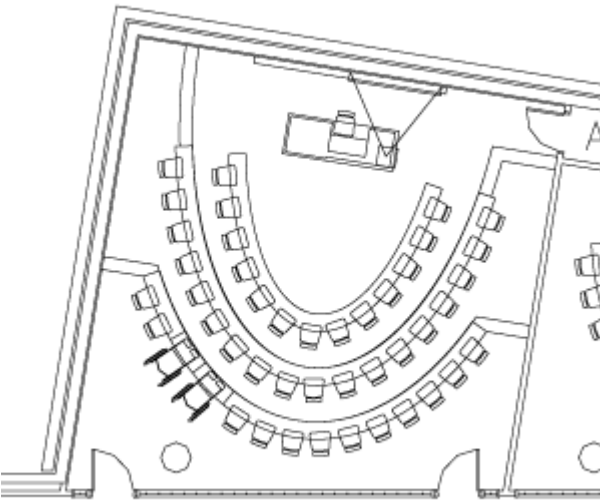

R2A

Pro  
Finish

Con  
No through aisles  
Lighting levels far too low (16FC)  
Oversize custom table/podium too large and low  
Screen too small (6'6 ) and off center